

OPW 190 and 210 High-Flow Nozzle

For High-Flow, Bulk Fuel Oil Delivery Service.

Designed to handle high flow when line pressure is not a critical consideration or otherwise absorbed.

Key Features

- **Aluminium Body** - lighter weight, easier to maneuver.
- **Dual Poppets** - allows for low-flow metering (not intended for high pressure pump applications).
- **Replaceable Hold-Open Rack** - for use when fueling large-capacity tanks. Nozzle must be attended at all times during usage.
- **Dash Pot** - non-adjustable, to minimize closing line shock.
- **Right Angle Design** - provides larger lever area for better grip and easier control; permits nozzle to fit into awkward spaces close to walls and into corners.
- **Drag Lugs** - protect the nozzle when dragged across rough surfaces; enhances long-life durability.
- **Easily Replaced Spout** - the spout is easily threaded into the body. Replacement spouts are readily available from Liquip OPW.
- **NPT or BSP Female Threads at Inlet End** - standard pipe threads accept all standard 1-1/4" and 1-1/2" male connections.
- **Designed working pressure** - 50 psi max pressure.

Technical Information

Materials of Construction

Body - Cast Aluminium
Main Stem - Stainless Steel
Stem Seal - Graphite with Teflon
Disc - Viton
Spout - OPW 296 brass or 297 alum (optional)

Ordering Information

Item	Description
LIQ210L0104LLIQUIP	NOZZLE MANUAL 1 1/4" BSPP C/W SPOUT OPW 210 SERIES HIGH FLOW
LIQ210L0105LLIQUIP	NOZZLE MANUAL 1 1/2" BSPP C/W SPOUT OPW 210 SERIES HIGH FLOW
LIQ1290L-075L	NOZZLE AUTO 1 1/2" BSPP INCLUDES OPW SPOUT
LIQ210-0104	NOZZLE MANUAL 1 1/4" NPT VITON OPW WITH DASHPOT, NO SPOUT
LIQ210-0105	NOZZLE MANUAL 1 1/2" NPT VITON OPW WITH DASHPOT, NO SPOUT

Contact Liquip for 190 series parts requests.

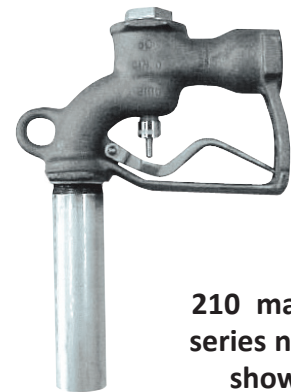

210 manual series nozzle shown

OPW 190 High-Flow Nozzles

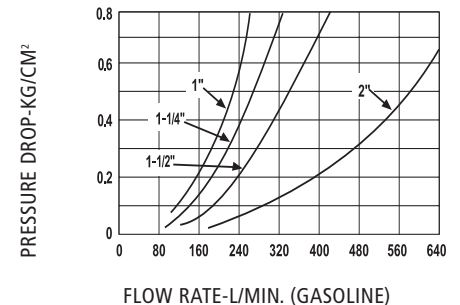
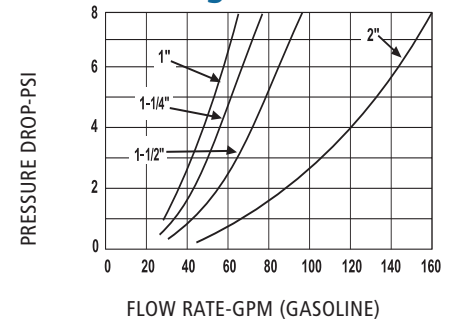

OPW 210 Manual High-Flow Nozzles

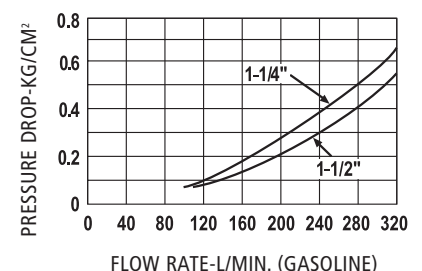
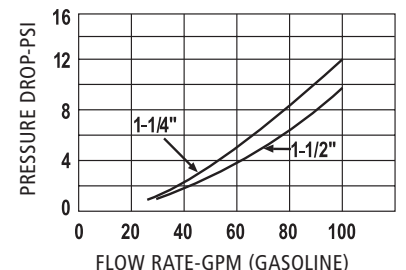

210 Nozzle Associated Equipment - Spares

Key	Item	Description	Status
1	H00195RB	Stuffing Box	Stocked
2	C04495M	Packing	Stocked
3	H07012M	Packing Gland	Stocked
4	H05719RE	Stem*	On Request
5	H00113RA	Packing Nut	On Request
6	H01841	Lower Disc S/A*	Stocked
7	190K-0001	Upper Poppet	Stocked
8	H01461AH	Cap	On Request
9	H00999M	Lever	Stocked
10	H08165RE	Pin	On Request
11	H08163M	Push Nut (2 required)	Stocked
12	H00136M	Spring	On Request
13	297-9020	Spout (optional) 1 1/4" aluminium	Stocked
13	297-9030	Spout (optional) 1 1/2" aluminium	On Request
13	296-0040	Spout (optional) 1 1/4" brass	On Request
13	296-0060	Spout (optional) 1 1/2" brass	On Request
14	C04698M	Rack	On Request
14	H14105M	Screw	On Request

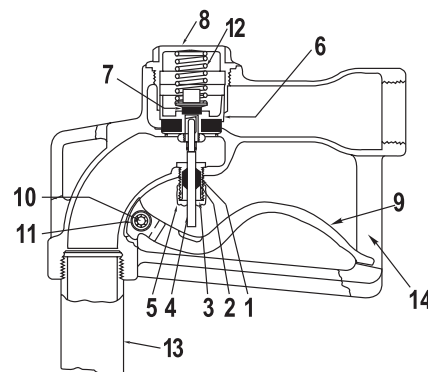

*Replacement parts for nozzles built after 1998. Parts are unavailable for nozzles built before this date.

Materials

Cable: Steel

Ground Plug:

Stainless steel

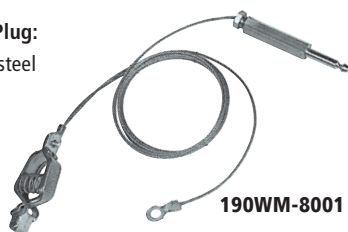

190WM-8001

Ordering Specifications

Product #	Length		Used On
	ft.	m	
190WM-8001	6'	1.83	295SA
190WF-8002	6'	1.83	295AF

Manual Nozzle Accessories OPW 190 Ground Wire

The OPW 190 ground wire assembly is designed for use on 295 series aircraft nozzles. The OPW 190WM is designed for use with the 295SA and includes a cable, attaching eyelet, ground plug and clamp. The OPW 190WF is for use with the 295AF aircraft nozzle and includes a cable, eyelet, ground plug and dust cap.

Materials

Screen:

Stainless steel

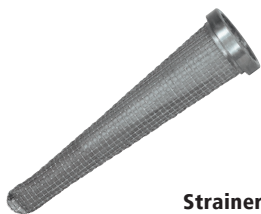

Strainer

Ordering Specifications

Product #	in.	mm	Used On
153-0910	1 1/2"	38	190G, 295SA
153J-0100	1 1/2"	38	295SAJ
190S-7063	1"	25	295SA Series w/ 1" Spout
153AF-0100	1 1/2"	38	295AF

OPW Strainers

OPW strainers prevent foreign matter from entering fuel tanks. They are held in position by a tube and have a 100-mesh screen.

Materials

Body: Anodized Aluminum

Spring: Bronze

Stem: Bronze

Disc: Buna-N



296CA

Body: Rubber

Spring: Bronze

Stem: Bronze

Disc: Buna-N



296CJ

Ordering Specifications

Product #	Size		Spout	Used On
	in.	mm		
296CA-4000	1 5/8"	41	296	190 1"
296CA-4005	1 5/8"	41	296	1 1/4", 1 1/2"
296CJ-0100	1 1/2"	38	696J only	295SAJ 1 1/2"
H10387	1"	26	297SA 1"	295SA
H10388	1 1/2"	38	297SA 1 1/2"	295SA

OPW 296 Protective Caps

OPW 296 Protective Caps are for use with OPW 296 and 297SA nozzle spouts. Each cap also comes with a chain and tension spring. The size ordered should be the same size as the spout O.D.